

nosiboo^{*}go[®]
portable nasal aspirator



nosiboo^{*}go[®]
portable nasal aspirator

Before using the Nosiboo Go, carefully read this guide and the **User Manual** as well! Please keep this guide for future reference.

Pingo & Nosiboo

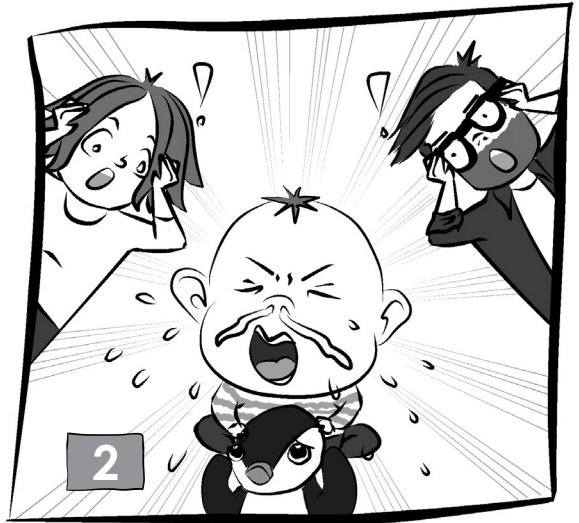



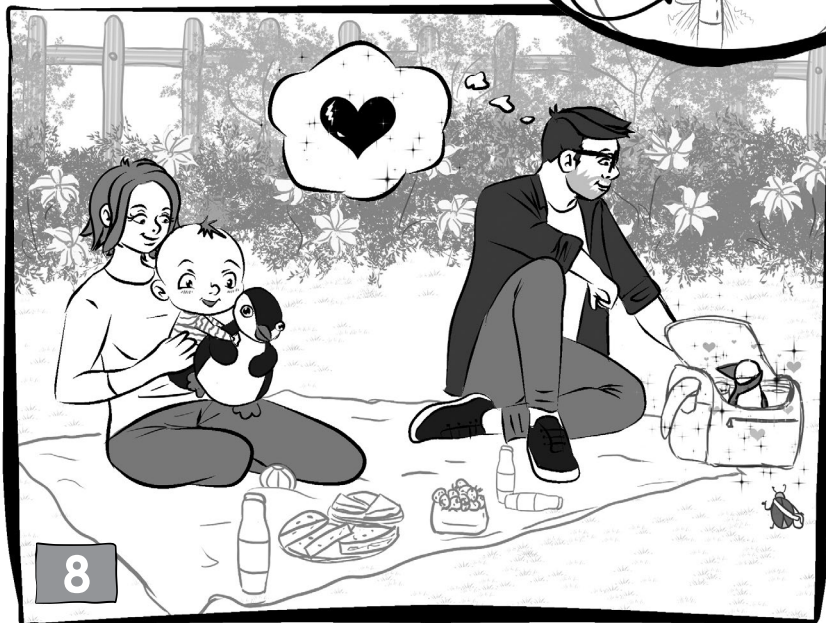
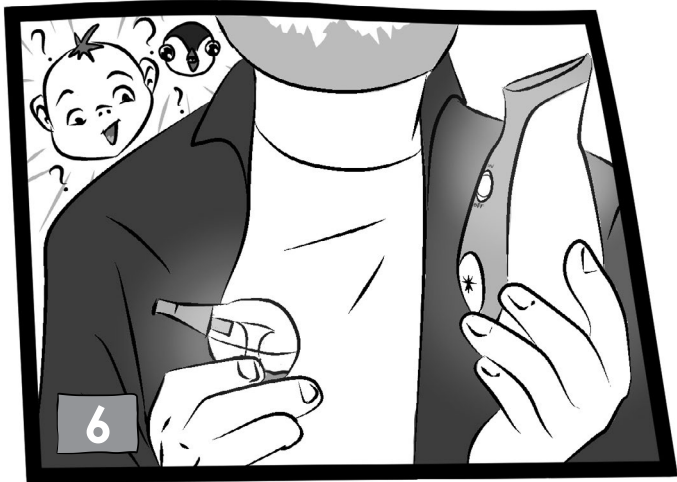

IN THE BOX

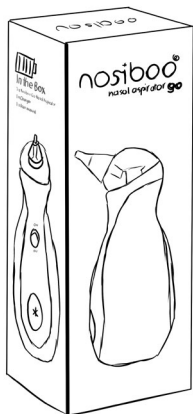

Quick start guide



Safety instructions



Nosiboo Go

Charger



Penguin head
+Nose tip



Air mesh



Brush



Sack

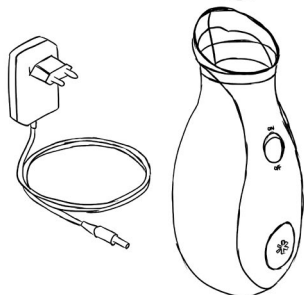

Contact the distributor if any part is missing!

USING THE NOSIBOO GO

The device should be used for removing the nasal mucus from children's nose. It should not be used for any other purposes.

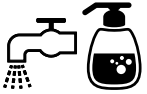

First clean* and dry the parts of the Penguin head.

*Check the "CLEANING" section below for more details about the proper cleaning method.

Assemble the Penguin head.

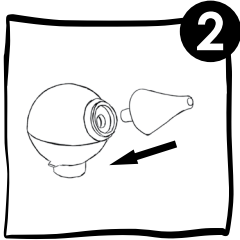
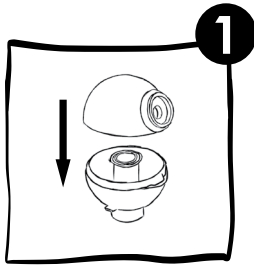

Insert the nose tip into the Penguin head.

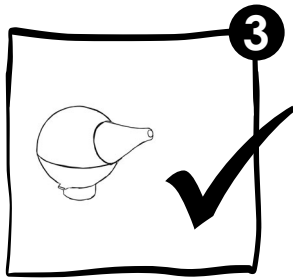

Make sure the air mesh is in its place, the Penguin head is assembled properly and installed on the device in the correct way.

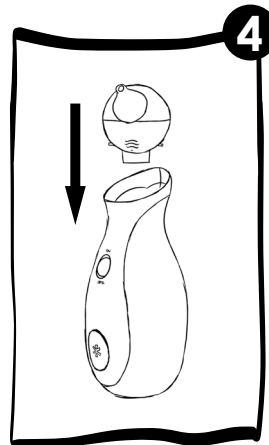

The device is ready to use.

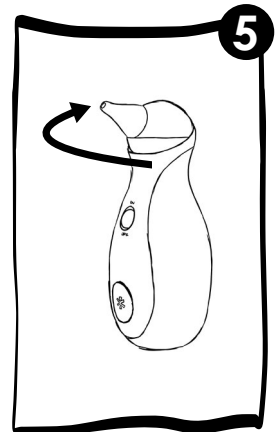

INSTRUCTIONS FOR USE & SETTINGS

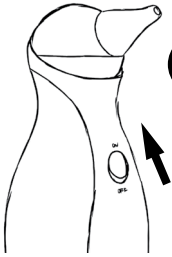

1 Getting started

Simply turn it on.



The effective and strong (max.) suction power has been proven safe for nasal aspiration by ENT doctors.

2 Hold your child in a stable position.

- * Aspirate the nose of infants after laying them into a stable position and hold their head during the process.
- * You may also sit them in an infant bouncer or infant seat.
- * If the child is already able to sit, sit them in your lap. In this case, do not lay the child on their back during the aspiration.



3 Insert the clean, dry nose tip into the child's nostril.

- * Move the nose tip around gently to make sure that you get all areas of the nostril.



If you experience that mucus or liquid has entered the device then stop using the Nosiboo Go, turn it off and contact the Nosiboo customer service team right away.

- * Don't turn the device upside down meanwhile use.

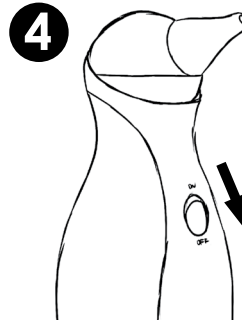

4 Switch off the device after use.

- * We highly recommend to remove the Penguin head and clean it right away.

5 Charging

- * After use, or if the device's battery just ran low, wait a few minutes until the device cools down and then start charging it.
- * Green LED - Fully charged
- * Red LED - Still charging
- * While being charged, the device cannot be used.

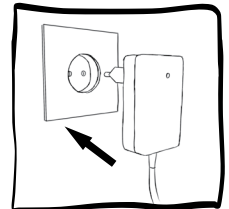

CLEANING

Detach the Penguin head in the following order:

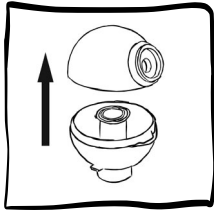
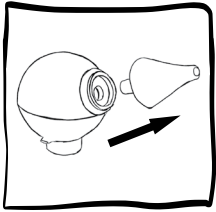

* Wash the parts with liquid soap and lukewarm water.

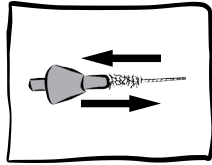

Use the brush to clean the nose tip.



* You can soak the parts in a disinfection liquid, just make sure the liquid is safe to use for baby equipment.



* Let the parts dry completely before the next use.

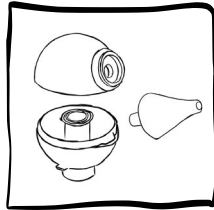

* It is not allowed to use boiling water, microwave oven, vaporizer or baby bottle sterilizer for cleaning the spare parts because they might deform by heat!

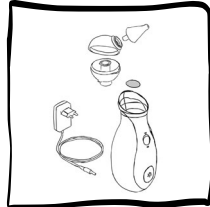

- * The air mesh is there to prevent solid objects and dust from entering the housing.
- * The air mesh is not there to absorb any mucus or liquid.
- * If the air mesh is dirty or clogged, you can replace it.
- * It can function well for a very long time next to the proper usage of the device.

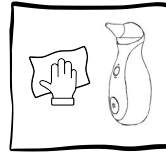

- * Clean the housing with a dry, soft cloth.
- * Do not use any liquids, detergents or chemicals.
- * Keep the device in a place where it is protected from dust, direct sunlight and heat.

HINTS & TIPS

- * The Penguin head must be assembled and disassembled in the right order.
- * Do not cover the vents on the back of the device while in use.
- * Dry, very thick mucus can be dissolved by a mild saline solution. After using it, wait a few minutes, wipe excess discharge with a tissue, then reuse the nasal aspirator as directed.
- * Do not use more than 5 ml of saline solution at once.



- * The device should only be used by adults.
- * Do not allow children to play with the device, it is NOT A TOY.





User manual

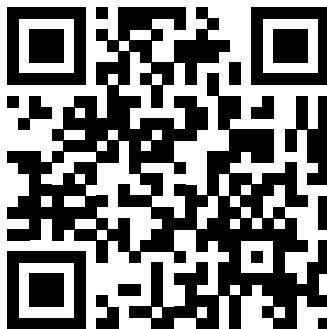

AFTER-SALE SERVICE

For more information about usage, cleaning, and for troubleshooting, see the User Manual.

customers in EU: nosiboo.eu
customerservice@nosiboo.com

nosiboo[®]
designed to care

IT

nosiboo^{*}go[®]
portable nasal aspirator

Prima di usare Nosiboo Go, legga attentamente questa guida ed anche il **Manuale d'istruzioni**. Conservi questa guida per consultazione futura.

Pingo & Nosiboo

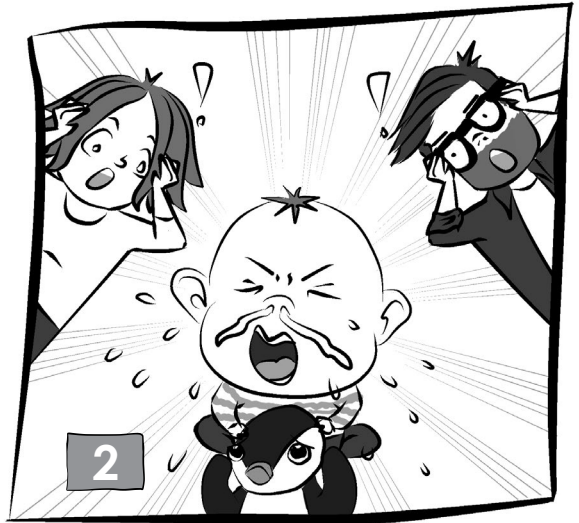



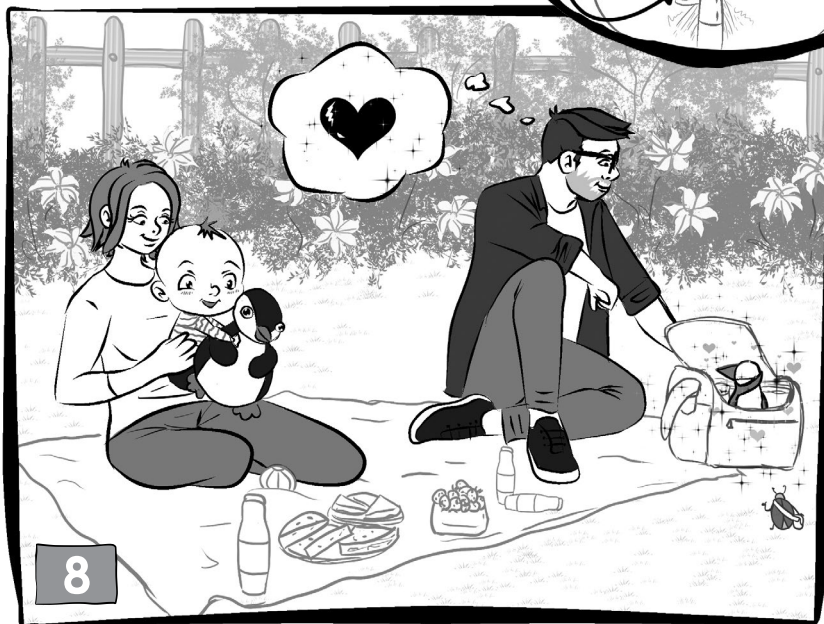
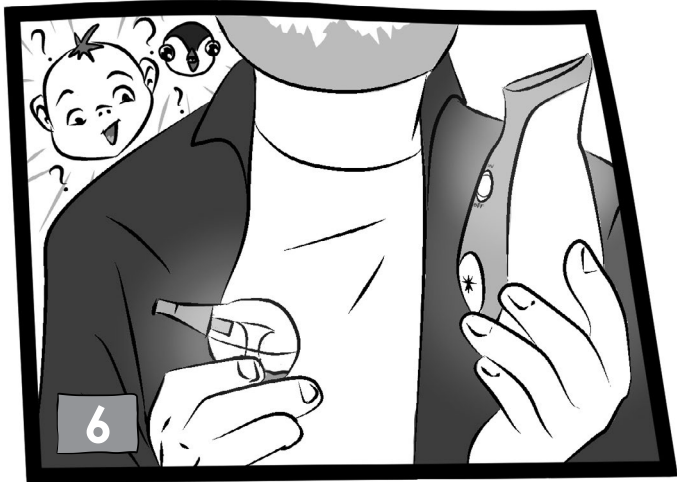

NELLA SCATOLA

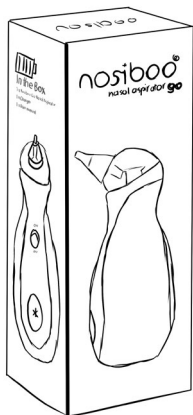

Guida rapida



Istruzioni di
sicurezza



Nosiboo Go

Caricatore



Beccuccio Penguin
+Beccuccio anatomico



Filtro ricambiabile

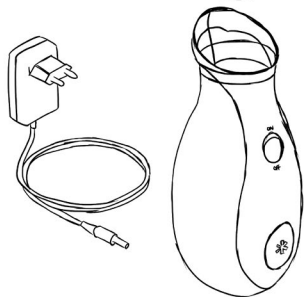

Spazzolino



Sacca



Contatti il distributore in caso di parti mancanti!

COME USARE NOSIBOO GO

Il dispositivo deve essere usato per rimuovere il muco nasale dal naso dei bambini. Non deve essere utilizzato per altri scopi.

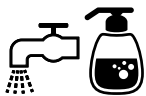

Per prima cosa pulire* e asciugare le parti del beccuccio Penguin

*Controllare la sezione "PULIZIA" di seguito per maggiori dettagli sul metodo di pulizia appropriato.

**Montaggio del
beccuccio
Penguin.**

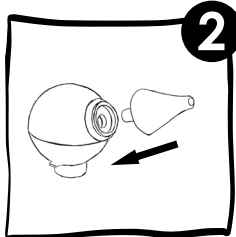
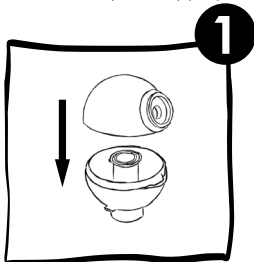

**Inserire il beccuccio
anatomico nel
beccuccio Penguin.**

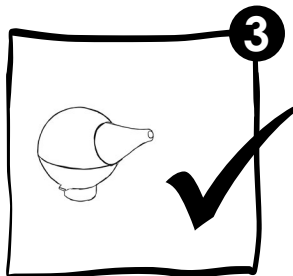

Assicurarsi che il filtro ricambiabile sia in posizione, e che il beccuccio Penguin sia montata correttamente e installata sul dispositivo nel modo corretto.

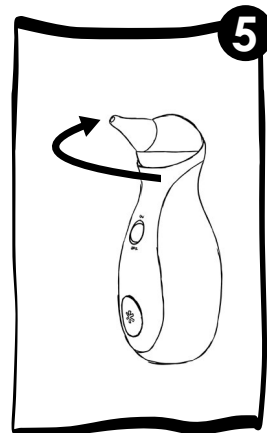
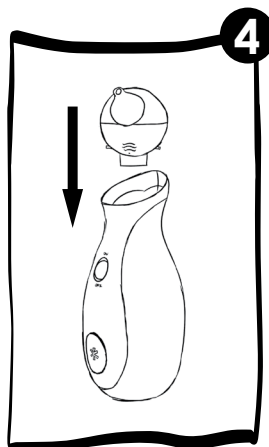

**Il dispositivo è
pronto per l'uso.**

ISTRUZIONI PER L'USO E IMPOSTAZIONI

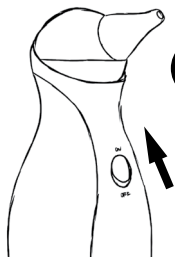

- 1** **Per iniziare**
Accendere il dispositivo.



I medici ENT hanno confermato che il potere aspirante efficace e forte (max.) è sicuro per l'aspirazione nasale.

Tenere il bambino in una posizione stabile.

- * Aspirare il naso del bambino dopo averlo fatto sdraiare in una posizione stabile; sostenere la testa del bambino durante il processo.
- * Può anche farlo sedere su una sdraietta o un seggiolone.
- * Se il bambino è già in grado di stare seduto, lo può fare sedere sulle sue ginocchia. In tal caso non deve fare sdraiare il bambino sulla schiena durante l'aspirazione.



3 **Inserire il beccuccio anatomico pulito, asciutto nella narice del bambino.**

- * Fare ruotare delicatamente il beccuccio anatomico per assicurarsi di raggiungere tutte le aree della narice.



Se si accorge che il muco o il liquido è entrato nel dispositivo, interrompa l'uso di Nosiboo Go, lo spenga e contatti immediatamente il servizio assistenza Nosiboo.

- * Non capovolgere il dispositivo durante l'uso.

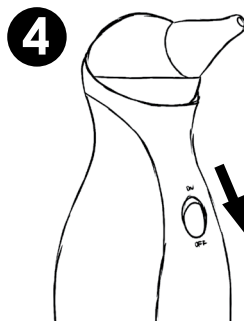
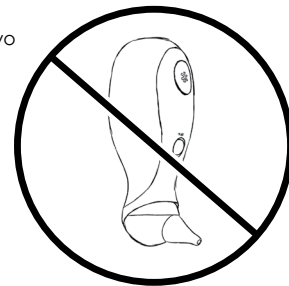

4 **Spegnere il dispositivo dopo l'uso.**

- * Raccomandiamo fortemente di rimuovere il Beccuccio Penguin e di pulirli subito!

5 **Caricamento**

- * Dopo l'uso, o se la batteria del dispositivo si sta scaricando, aspettare alcuni minuti fino a quando il dispositivo si sia raffreddato e quindi iniziare a caricarlo.
- * LED verde - Completamente carico
- * LED rosso - In carica
- * Durante la carica il dispositivo non può essere usato.

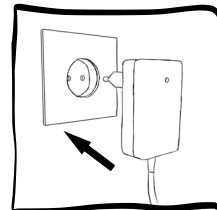

PULIZIA

Staccare il beccuccio Penguin nell'ordine seguente:

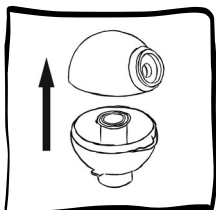
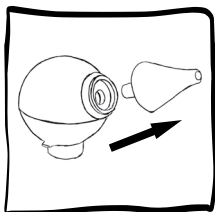

* Lavare le parti con sapone liquido e acqua tiepida.

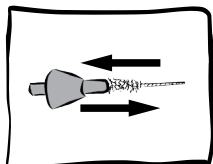

Usare lo spazzolino per lavare il beccuccio anatomico.



* Può immergere le parti in un liquido disinfettante. Assicurarsi che il liquido sia sicuro per l'uso con dispositivi per bambini.



* Lasciare asciugare completamente le parti prima dell'utilizzo successivo.



* Non devono essere usati acqua bollente, forno a microonde, vaporizzatore o sterilizzatore di biberon per pulire i pezzi di ricambio poiché questi potrebbero essere deformati dal calore!

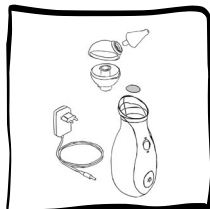
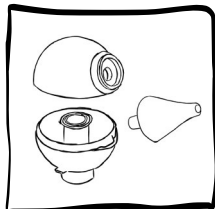

- * Il filtro ricambiabile serve a prevenire l'ingresso oggetti solidi e polvere nella custodia.
- * Il filtro ricambiabile non serve ad assorbire muco o liquido.
- * Se il filtro ricambiabile si sporca o si intasa, può sostituirlo.
- * Con il corretto uso del dispositivo può funzionare bene per molto tempo.

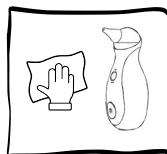

- * Pulire la custodia con un panno asciutto e morbido.
- * Non usare liquidi, detersivi o agenti chimici.
- * Tenere il dispositivo in un luogo in cui è protetto dalla polvere, dalla luce solare diretta e dal calore.

CONSIGLI E SUGGERIMENTI

- * Il beccuccio Penguin deve essere montata e smontata nell'ordine corretto.
- * Non coprire la ventilazione posteriore del dispositivo mentre è in uso.
- * Il muco secco, molto viscoso può essere sciolto con una soluzione salina leggera. Dopo averla usata, aspettare alcuni minuti, pulire l'eccesso che cola con un fazzoletto, quindi usare di nuovo l'aspiratore nasale come da istruzioni.
- * Non usare più di 5 ml di soluzione per volta.



- * Il dispositivo deve essere usato solo da adulti.
- * Non permettere ai bambini di giocare con il dispositivo, NON È UN GIOCATTOLO.





Manuale d'istruzioni

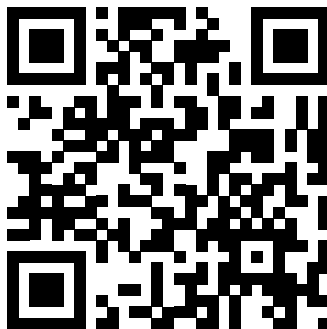

SERVIZIO POST-VENDITA

Per ulteriori informazioni sull'uso, la pulizia e la risoluzione dei problemi, vedere la sezione manuale d'istruzioni.

clienti nell'UE: [nosiboo.eu](https://www.nosiboo.eu)
customerservice@nosiboo.com



designed to care

FR

nosiboo^{*}go[®]
portable nasal aspirator

Avant d'utiliser le Nosiboo Go, lisez attentivement ce guide ainsi que le **manuel d'utilisation** ! Veuillez conserver ce guide pour toute consultation ultérieure.

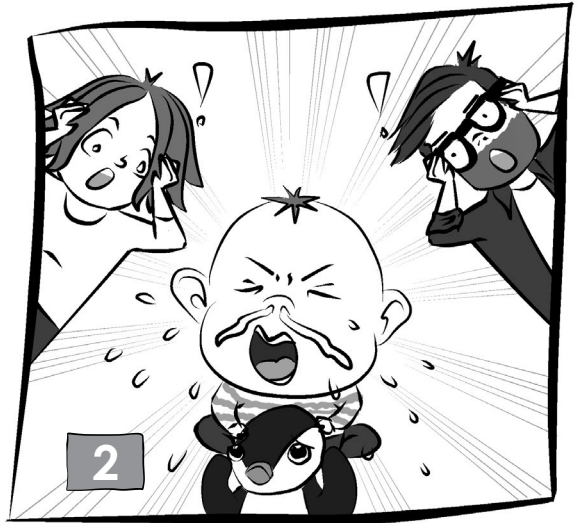
Pingo & Nosiboo





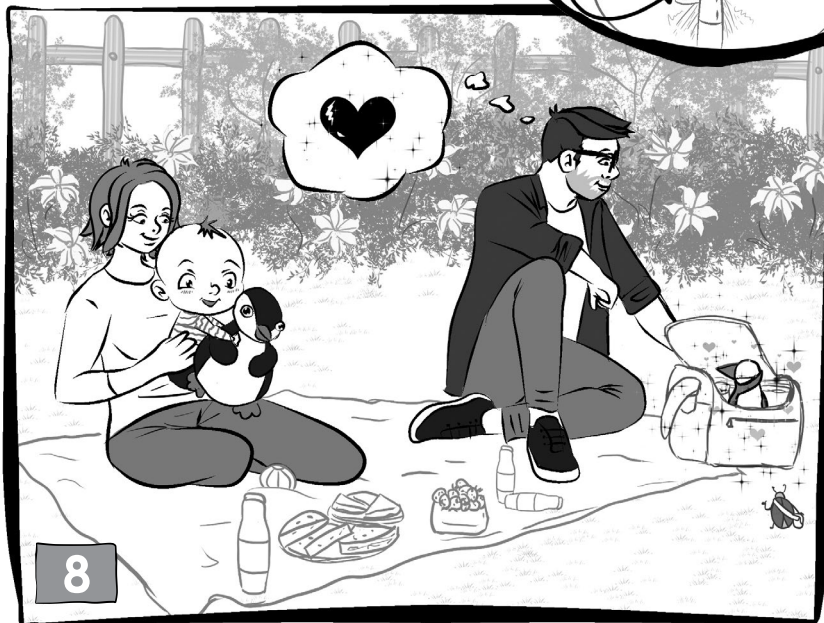

CONTENU DE LA BOÎTE

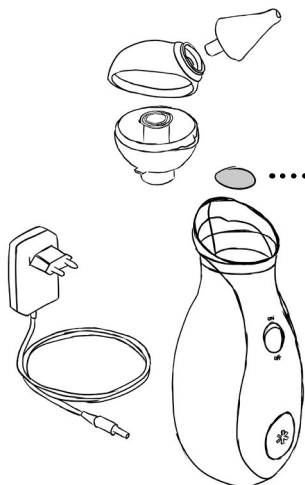
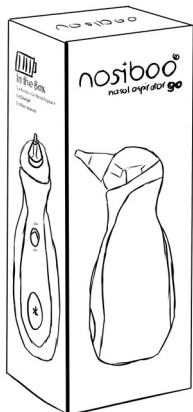

Guide de démarrage rapide



Consignes de sécurité



Nosiboo Go

Chargeur



Tête Penguin + Bec de la tête



Maillage de l'air

Brosse



Sachet



Contactez le distributeur si une pièce manque !

UTILISATION DU NOSIBOO GO

L'appareil doit être utilisé pour enlever le mucus nasal du nez des enfants. Il ne doit pas être utilisé à d'autres fins.



Nettoyez* et séchez d'abord les pièces de la tête Penguin.

*Consultez la section « NETTOYAGE » ci-dessous pour plus de détails sur la méthode de nettoyage appropriée.

Assemblez la tête Penguin.

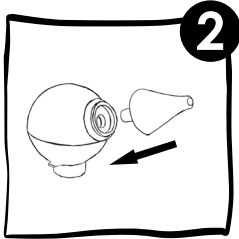
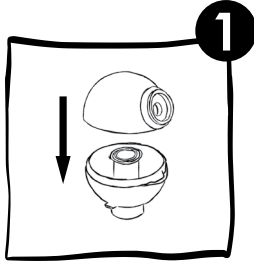

Insérez le bec de la tête dans la tête Penguin.

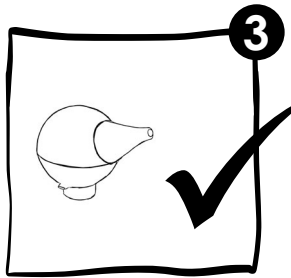

Assurez-vous que le maillage de l'air est à sa place, que la tête Penguin est correctement assemblée et installée sur l'appareil de la bonne manière.

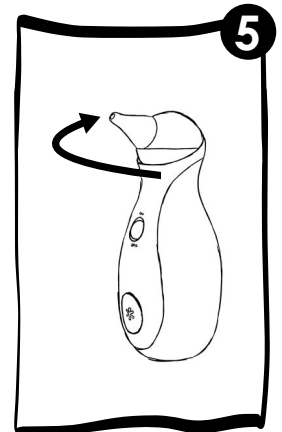
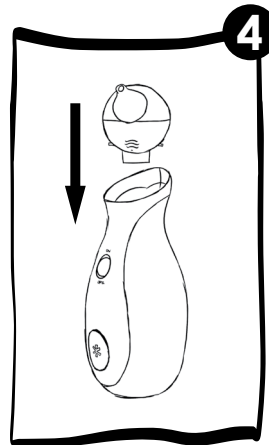

L'appareil est prêt à l'emploi.

INSTRUCTIONS D'UTILISATION ET RÉGLAGES

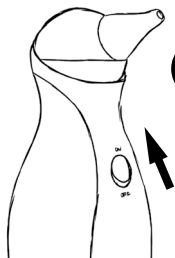

- 1** Pour commencer
Il suffit de l'allumer.



La sûreté de la puissance d'aspiration efficace et forte (max.) a été prouvée pour l'aspiration nasale par les médecins ORL.

Maintenez votre enfant dans une position stable.

- * Aspirer le nez de l'enfant après l'avoir mis dans une position stable et maintenez sa tête pendant l'opération.
- * Vous pouvez également les faire asseoir dans un transat ou un siège pour bébé.
- * Si l'enfant est déjà capable de s'asseoir, faites-le asseoir sur vos genoux. Dans ce cas, n'allongez pas l'enfant sur le dos pendant l'aspiration.



Insérez le bec de la tête propre et sec dans la narine de l'enfant.

- * Déplacez doucement le bec de la tête pour vous assurer d'atteindre toutes les zones de la narine.



Si vous constatez que du mucus ou du liquide a pénétré dans l'appareil, arrêtez d'utiliser le Nosiboo Go, éteignez-le et contactez immédiatement le service clientèle de Nosiboo.

- * Ne retournez pas l'appareil pendant son utilisation.



4



Éteignez l'appareil après utilisation.

- * Nous vous recommandons vivement de retirer la tête Penguin et de la nettoyer immédiatement !

5

Recharge

- * Après utilisation, ou si la batterie de l'appareil vient de se décharger, attendez quelques minutes que l'appareil refroidisse, puis commencez à le recharger.
- * LED verte – Complètement chargé
- * LED rouge – En cours de recharge
- * Pendant la recharge, l'appareil ne peut pas être utilisé.

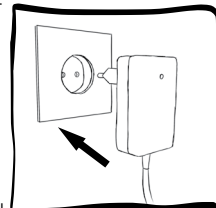

NETTOYAGE

Détachez la tête Penguin dans l'ordre suivant :

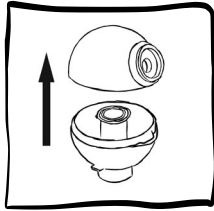
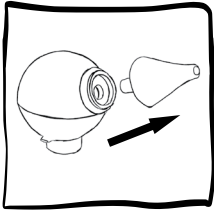

* Lavez les pièces avec du savon liquide et de l'eau tiède.

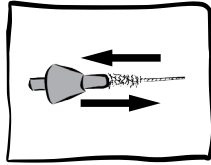

Utilisez la brosse pour nettoyer le bec de la tête.



* Vous pouvez faire tremper les pièces dans un liquide désinfectant. Veuillez vous assurer que le liquide est sans danger pour les équipements pour bébés.



* Laissez les pièces sécher complètement avant la prochaine utilisation.



* Il est interdit d'utiliser de l'eau bouillante, un four à micro-ondes, un vaporisateur ou un stérilisateur de biberon pour nettoyer les pièces car elles pourraient se déformer sous l'effet de la chaleur !

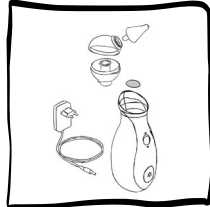
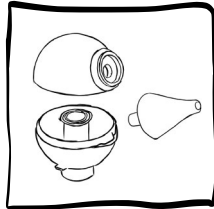

- * Le maillage de l'air est là pour empêcher les objets solides et la poussière de pénétrer dans le boîtier.
- * Le maillage de l'air ne sert pas à absorber le mucus ou le liquide.
- * Si le maillage de l'air est sale ou bouché, vous pouvez le remplacer.
- * Il peut bien fonctionner pendant très longtemps si l'appareil est utilisé correctement.

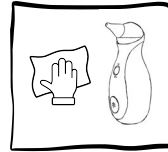

- * Nettoyez le boîtier avec un chiffon doux et sec.
- * N'utilisez pas de liquides, de détergents ou de produits chimiques.
- * Conservez l'appareil dans un endroit à l'abri de la poussière, de la lumière directe du soleil et de la chaleur.

CONSEILS ET ASTUCES

- * La tête Penguin doit être montée et démontée dans le bon ordre.
- * Ne couvrez pas les orifices de ventilation à l'arrière de l'appareil pendant l'utilisation.
- * Un mucus sec et très épais peut être dissous avec une solution saline douce. Après l'avoir utilisée, attendez quelques minutes, essuyez l'excès de mucus avec un mouchoir en papier, puis réutilisez l'aspirateur nasal en suivant les instructions.
- * N'utilisez pas plus de 5 ml de solution saline à la fois.



- * L'appareil ne doit être utilisé que par des adultes.
- * Ne laissez pas les enfants jouer avec l'appareil, CE N'EST PAS UN JOUET.





Manuel d'utilisation

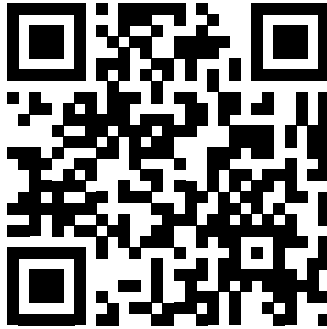

SERVICE APRES-VENTE

Pour plus d'informations sur l'utilisation,
le nettoyage et en cas de problèmes,
consultez le manuel d'utilisation.

les clients dans l'UE : nosiboo.eu
customerservice@nosiboo.com

nosiboo^{*}®
designed to care

nosiboo^{*}go[®]
portable nasal aspirator

Nosiboo Go をご使用になる前に、このガイドと使用説明書をよくお読みください。必要な時に参照できるようにこのガイドを保管してください。

同梱物

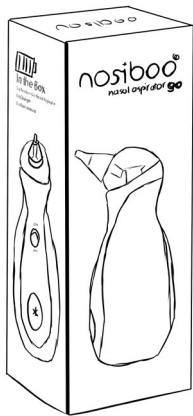

クイックスタート
ガイド



安全上の注意



Nosiboo Go

充電器



ペンギンヘッドと
ノーズチップ



エアメッシュ

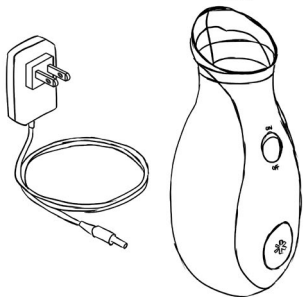

ブラシ



袋



万一足りない部品がございましたら、販売店までご連絡ください。

NOSIBOO GO の使い方

本製品は、お子様の鼻から鼻水を取り除くためのものです。その他の目的でご使用にならないください。

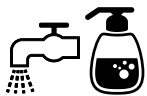

最初にペンギンヘッドの部品を洗浄し*、乾かします。

* (適切な洗浄方法の詳細については、下記の「洗浄」セクションをお読みください。)

ペンギンヘッドを
組み立てます。

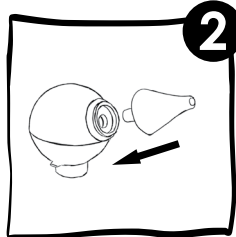
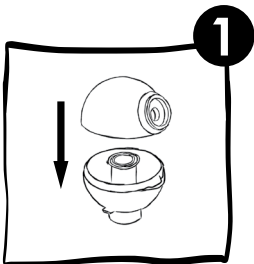

ノーズチップをペンギン
ヘッドに挿入します。

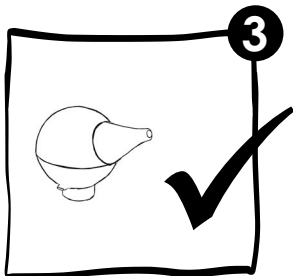

エアメッシュを定位置に設置し、ペンギンヘッドを適切に組み立て、正しい方法でデバイスに取り付けてください。

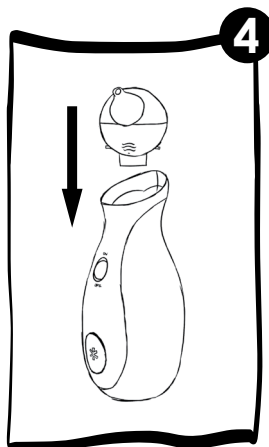

これで、デバイスを使用する準備は完了です。

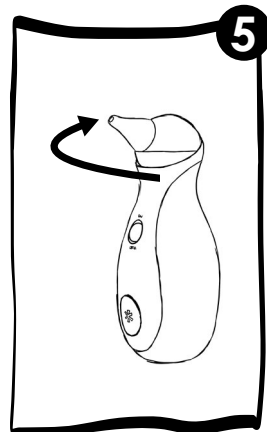

使用および設定方法

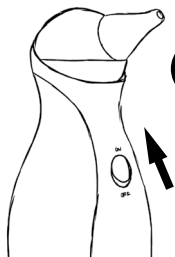

1 はじめに
スイッチを入れます。



効果的かつ強力な（最大時）吸引力で鼻を安全に吸引できることを耳鼻咽喉科医が実証済みです。

2

赤ちゃんを安定した姿勢に保ちます

- * 乳児を安定した姿勢で寝かせてから鼻を吸引し、吸引中は頭を支えます。
- * 乳児用バウンサーや乳児用の椅子に座らせてもかまいません。
- * 赤ちゃんがお座りできる場合は、膝の上に座らせてください。その場合、吸引する時は仰向けに寝かせないでください。



3

清潔な乾いたノーズチップを赤ちゃんの鼻に挿入します。

- * ノーズチップをやさしく動かして、鼻孔全体にあたるようにしてください。



鼻水や液体が本製品に入った場合は、Nosiboo Goの使用を停止し、電源を切って、すぐにNosibooカスタマーサービスチームまでご連絡ください。

- * 使用中は本製品を逆さにしないでください。

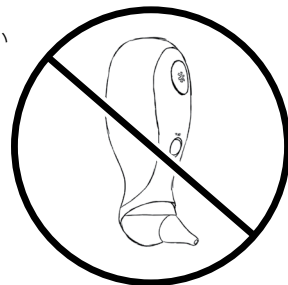

4

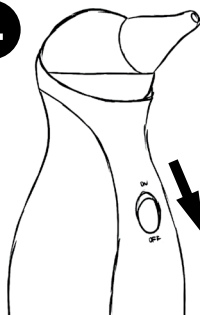

使用後にスイッチを切ります。

- * すぐにペンギンヘッドを取り外して洗浄することを強くお勧めします！

5

充電

- * 使用后、または電池が少なくなった場合、本製品の温度が下がるまで数分間待ってから
- * 緑のLED - 充電完了
- * 赤のLED - 充電中
- * 充電中は本製品を使用できません。

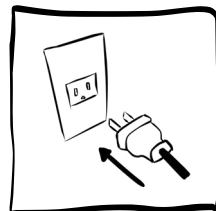

洗浄

ペンギンヘッドを次の順で取り外します。

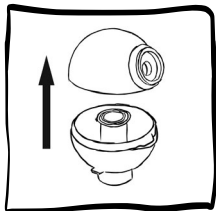
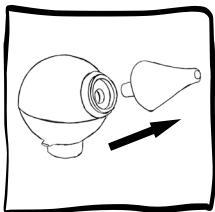

* 液体せっけんをぬるま湯で部品を洗います。

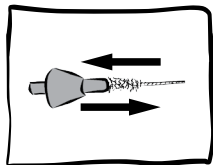

ブラシを使用してノズルチップを洗浄します。



* 部品を消毒液につけることもできます。必ず赤ちゃん用装置に使用しても安全な消毒液をご使用ください。



* 次回使用する場合は、部品を完全に乾かしてから使用してください。

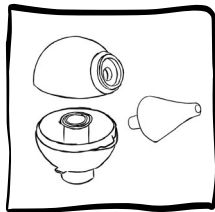

* 熱で部品が変形する可能性があるため、熱湯、電子レンジ、噴霧器、哺乳瓶滅菌器を使用してスペア部品を洗浄しないでください。



- * エアメッシュは固形物やほこりがハウジング内に入るのを防ぐためのものです。
- * エアメッシュは鼻水や液体を吸収するものではありません。
- * エアメッシュが汚れたり詰まったりした場合は、交換してください。
- * 本製品を適切に使用した場合、エアメッシュは非常に長期間機能します。

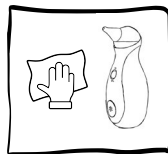
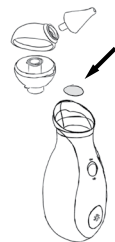

- * ハウジングを乾いた柔らかい布で拭いてください。
- * 液体、洗剤、化学薬品は使用しないでください。
- * ほこりがなく、直射日光が当たらない涼しい場所でデバイスを保管してください。

ヒントとポイント

- * ペンギンヘッドは正しい順番で組み立て、分解してください。
- * 使用中は、本製品の背面にある換気口を覆わないでください。
- * 鼻水が乾き、非常に濃い場合は、薄い食塩水で溶かすことができます。食塩水を使用して数分間待ってから、食塩水で溶けた鼻水をティッシュでふき取り、再び手順に従って鼻水吸引器を使用します。
- * 一度に5ml以上の食塩水を使用しないでください。



- * 本製品は必ず大人が使用してください。
- * お子様に本製品で遊ばせしないでください。これはおもちゃではありません。

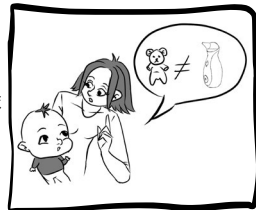



사용설명서

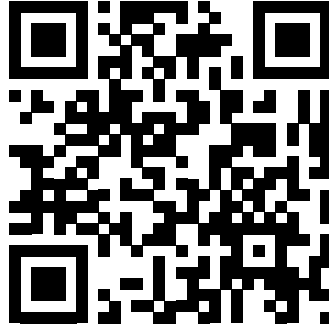
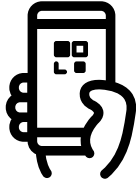

A/S 서비스
사용법, 세척 및 문제 해결에 대한 더 자세한 내용은 사용자 매뉴얼을 참고해 주세요.

한국 내의 고객 : nosiboo.kr
customer@nosiboo.kr
+82 (0)2-419-3927

nosiboo®
designed to care

JP

nosiboo^{*}go[®]
portable nasal aspirator

Nosiboo Go 사용 전 이 가이드와
사용 설명서를 주의 깊게 읽어주십시
오! 나중에 참조할 수 있도록 이 가이
드를 보관해주십시오.

Pingo & Nosiboo

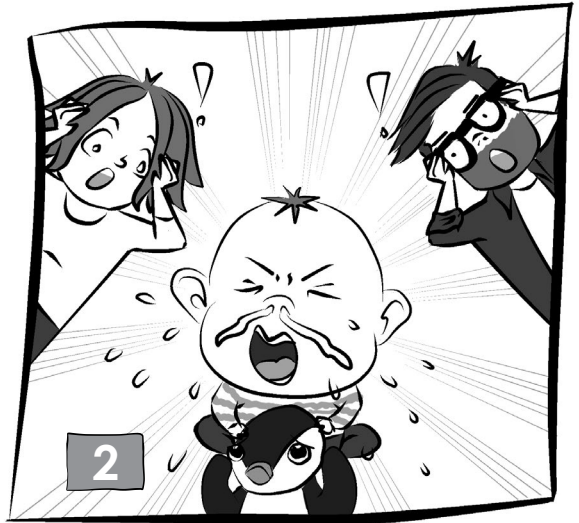



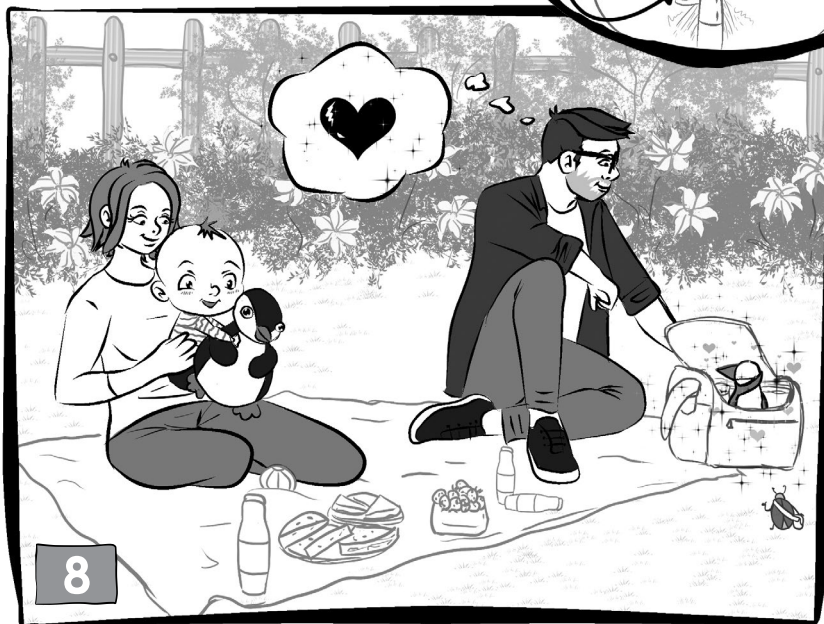
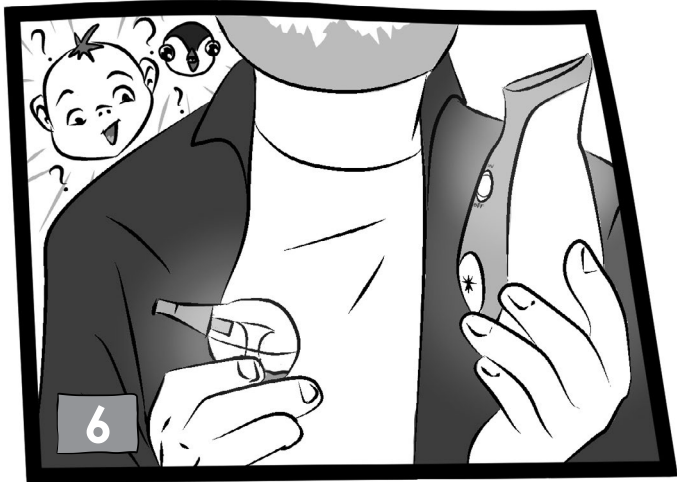

상자 내용물

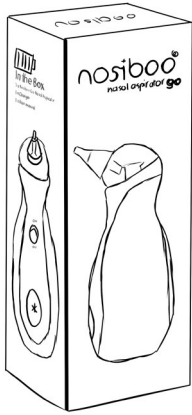

빠른 시작 가이드



안전 지침



Nosiboo Go

충전기



펭귄 헤드
+노즈 팁



에어 매쉬

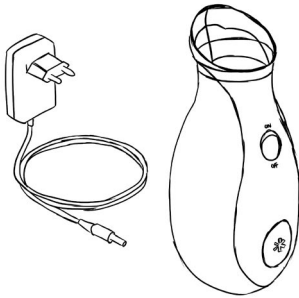

브러시



주머니



누락된 부품이 있다면 판매대리점에 연락해 주십시오!

NOSIBOO GO

사용하기

이 기기는 어린이의 코에서 콧물을 제거하는 용도로만 사용해야 합니다. 다른 용도로 사용해서는 안 됩니다.

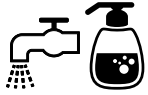

먼저 펭귄 헤드 부품을 세척한 다음* 건조합니다.

* (올바른 세척법에 대한 상세한 내용은 아래의 „세척 (CLEANING)” 섹션에서 확인합니다.)

펭귄 헤드를 조립합니다

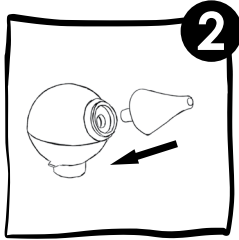
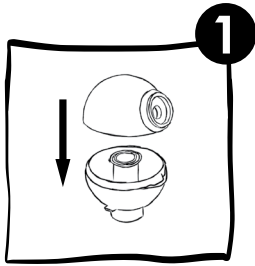

노즈 팁을 펭귄 헤드에 삽입합니다

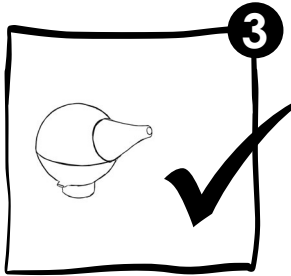

에어 매쉬가 제자리에 있으며 펭귄 헤드가 적절하게 조립되어 기기에 올바른 방식으로 설치되어 있는지 확인합니다.

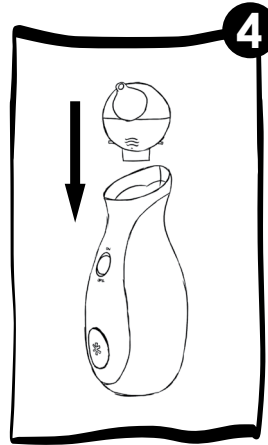

기기를 사용할 준비가 되었습니다.

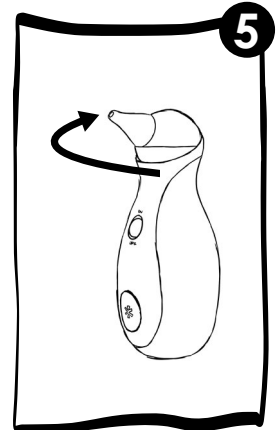

사용 및 설치 설명서

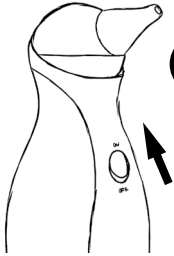

1 시작하기
기기의 전원을 켭니다.



효과적이고 강력한(최대) 흡입력은 ENT 의사로부터 콧물 흡입용으로 안전성을 입증받았습니다.

아이를 안정된 자세로 잡아줍니다.

- * 아이를 안정된 자세로 눕힌 후 아이의 머리를 잡은 상태에서 코에서 콧물을 흡입합니다.
- * 유아용 바운서 또는 유아용 의자에 앉힐 수도 있습니다.
- * 아이가 아직 앉을 수 없다면, 무릎에 앉힙니다. 이러한 경우, 흡입기를 사용할 때 바닥에 아이의 등을 대고 눕히지 않습니다.



3

깨끗하고 건조된 노즈 팁을 아이의 콧구멍에 삽입합니다.

- * 노즈 팁을 부드럽게 움직여 콧구멍 안 전체에 닿도록 합니다.



Nosiboo Go 사용 중 콧물이나 액체가 기기 안으로 들어가 기기가 작동을 멈추는 일이 발생하면, 전원을 끄고 바로 Nosiboo 고객 서비스 팀에게 연락해 주십시오.

* 사용 중에 기기를 거꾸로 들지 않습니다.



4

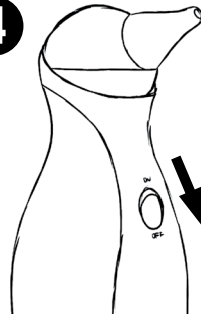

사용 후 기기의 스위치를 끕니다.

- * 펑귄 헤드를 분리한 후 바로 세척하실 것을 강력히 권장합니다!

5

충전하기

- * 사용 후 또는 배기기의 배터리가 막 다 닳은 경우, 기기가 식을 때까지 몇 분 기다리셨다가 충전을 시작합니다.
- * 녹색 LED - 완충됨
- * 적색 LED - 충전 중
- * 충전하는 동안 기기를 사용할 수 없습니다.

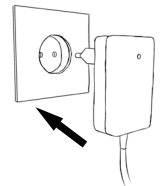

세척하기

펄컨 헤드를 다음 순서로 분리합니다:

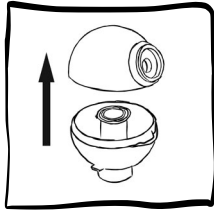
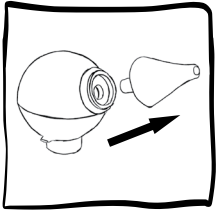

* 부품들을 액체 비누와 미지근한 물로 씻습니다.

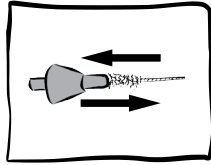

브러시를 사용해 노즐팁을 세척합니다.



* 부품들을 소독액에 담가놓을 수 있습니다. 아기 용품에 사용해도 되는 안전한 소독액인지 확인합니다.



* 다음 사용 전에 부품들을 완전히 건조합니다.



* 열에 의한 변형이 일어날 수 있기 때문에 예비 부품을 세척할 때 끓는 물, 전자레인지, 기화기 또는 젓병 소독기를 사용해서는 안 됩니다!

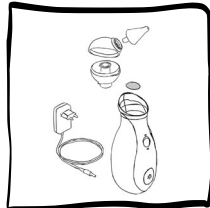
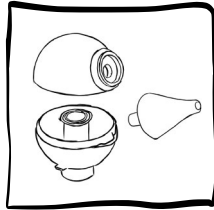

- * 에어 매쉬는 고형 물체와 먼지가 하우징 안으로 유입되는 것을 막는 역할을 합니다.
- * 에어 매쉬는 콧물이나 액체를 흡수하는 것이 아닙니다.
- * 에어 매쉬는 오염되거나 막히는 경우 교체하실 수 있습니다.
- * 이 기기는 올바른 용법으로 사용하면 아주 오랜 기간 동안 잘 작동할 수 있습니다.

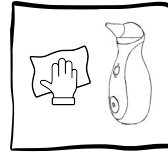

- * 부드러운 마른 천으로 하우징을 닦습니다.
- * 액체, 세제 또는 화학용품을 사용하지 않습니다.
- * 먼지, 직사광선, 열로부터 보호되는 곳에 기기를 보관합니다.

사용 요령 및 주의

- * 펄컨 헤드는 올바른 순서로 조립하고 분해해야 합니다.
- * 기기를 사용하는 동안 후면의 통풍구를 가리지 않습니다.
- * 건조 매우 진한 콧물은 순한 식염수로 녹일 수 있습니다. 사용 후 몇 분 기다렸다가 여분의 분비물을 티슈로 닦아낸 다음에 지시된 대로 콧물 흡입기를 재사용합니다.
- * 한 번에 5 ml 이상의 식염수를 사용하지 않습니다.



- * 이 기기는 성인만 사용해야 합니다.
- * 어린이가 기기를 갖고 놀지 않게 하십시오. 이 기기는 장난감이 아닙니다.





取扱説明書

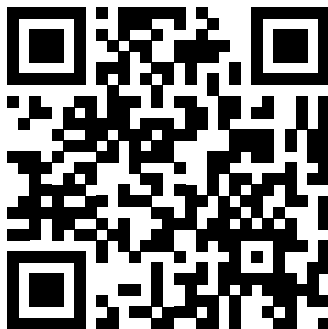

アフターサービス
使い方、洗浄方法、およびトラブルシュー
ティングの詳細については、取扱説明書
をご確認ください。

日本: nosiboo.jp
aidee@jct-inc.jp
Tel: 082-962-1701

受付時間: 平日9: 00~17: 00
株式会社ジェイ・シー・ティ

^{*}
nosiboo[®]
designed to care